



Instructional Technology Center

216 North 21st Street
Harlingen Texas, 78550

ExamView® Pro OnLine Testing

Background: ExamView® Pro v3.51 is a test generator which allows the development of test banks. From these test banks, tests can be built with all or some of the questions in any given bank, depending on specified criteria, and an accompanying answer sheet is developed. Once a test has been built, it can be printed or posted on-line. On-line tests can be posted to an Intra- or Internet. Truly secure on-line testing is provided by ExamView® for an annual license or subscription fee. More information is available at www.examview.com.

Post the Test on the Intra/Internet

- Prepare the Test in ExamView Pro.
- Create a link on a class web page as you feel appropriate
- Log into WS_FTP using the same User Name and Password as used for your class web pages.
- Upload or FTP the page containing the link and the file(s) related to the test.
 - There will be the test file as an .htm AND a folder of the same name (which contains the test graphics). Remember to upload or FTP *all* related files.



Instructing Students to Take the Test

- Direct students to take the test online.
 - Instruct them to complete the information at the top of the page and to answer the questions – the usual test directives.
 - If they leave a question blank, it will alert them and ask if they wish to end the test.
- Once complete, click Grade & Submit
- Answers & a grade will be sent to the teacher's email address (student is optional).
- If you formatted the test in ExamView® to Show Test Score to Student in Step 3 of Publishing to the Internet, the score will appear on the screen, otherwise it won't.
- It is a good idea to have them go Back to the test *after* they Submit their answers and Reset the test to clear the options.

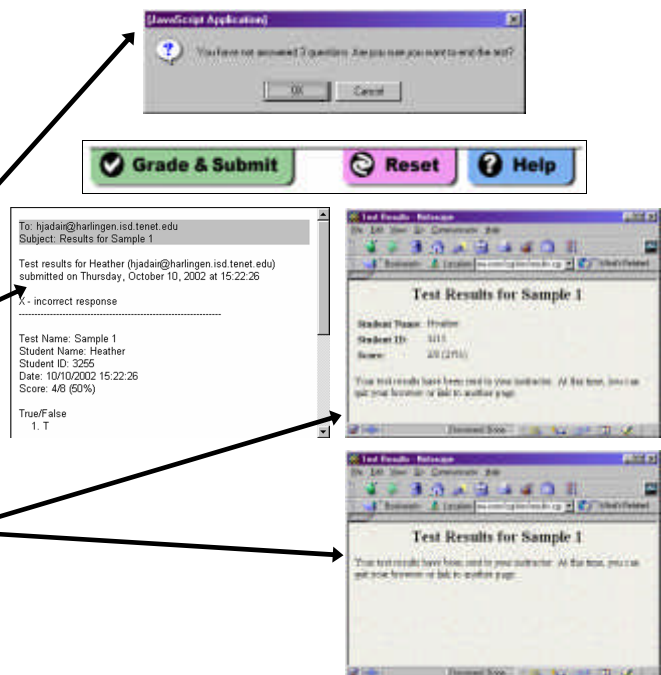

★ There are several issues related to posting tests online. They should be considered when administering tests in this manner. Some of these issues are addressed on the following page.

